

Contact us at:

For intake information
contact us at
773.734.2222 ext. 224
or info@scpfrc.org

For information
regarding making a donation
or volunteering contact us at
773.734.2222 ext. 227

Visit us on the web
www.scpfrc.org

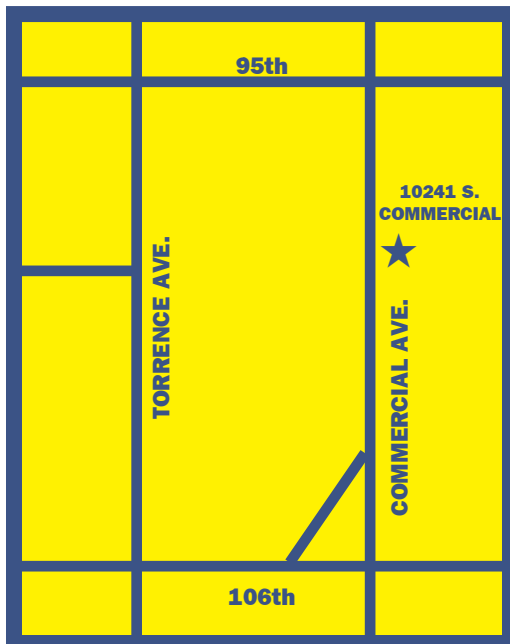

Providing Quality
Services to Persons with
Developmental Disabilities

*Serving Southeast Chicago
Since 1976*

10241 South Commercial
Chicago, Illinois 60617
773.734.2222 Voice
773.734.2850 Fax



Mission Statement

South Chicago Parents and Friends, strives to improve the quality of life for persons with developmental disabilities, enabling them to be productive, valued members of society.

To accomplish this goal, the services provided by South Chicago Parents and Friends allow individuals with disabilities to learn, work, play and live as all members of the community.

Our Services Include:

DEVELOPMENTAL TRAINING SERVICES

The Developmental Training Program provides individuals with developmental disabilities a variety of structured activities, designed to assist the individual in achieving their maximum potential. Individuals receiving Developmental Training services are provided instruction in vocational skills, self-care skills, adult daily living skills, communication, computer training, gross and fine motor skills and basic academic skills. Job training provides individuals the opportunity to develop and improve work attitude, skill acquisition and productive earning ability.

Developmental Training also offers senior citizens an alternative to the traditional Developmental Training services.

Services include community integration, arts and crafts, basic cooking, exercise classes and adult daily living skills.

EMPLOYMENT SERVICES

The Supported Employment program provides the necessary supports and services to assist individuals with developmental disabilities to work for compensation in a variety of community-integrated work environments. On location, job coaching by a trained agency staff member, is provided until natural supports with persons without disabilities are developed.

Community-Based Work Crews are placed on the job with trained agency staff members to ensure quality performance. Individuals learn how to become independent in completing tasks, while learning how to work effectively with fellow co-workers.

RECREATION SERVICES

The Leisure Arts and Music Program (L.A.M.P.) provides individuals with developmental disabilities the opportunity to experience and develop interests and activities of their own choosing. The program provides recreational and leisure services through an after-school and weekend program. Services may include, but are not limited to: community special events, sporting

events, individual interests, fieldtrips and sports training activities.

COMMUNITY SUPPORT SERVICES

Community Support Services provides an array of support services to individuals with developmental disabilities and their families in our service area.

In-Home Respite provides support services to help maintain individuals in their family home. A specially trained staff person provides one on one service, which allows the family member(s) some relief from the constant attention needed in caring for a family member with a developmental disability.

Home-Base Support Services are tailored to meet individuals' evolving needs and preferences for supports, without having to leave their family home. Individuals and families work with a service facilitation agency to develop an Individual Service Plan (ISP) in order to tailor the program to their personal needs.

Intake services provides family members with resource and referral information, which may include; guardianship, governmental benefits, transportation and DHS funded programs.